



**Stub shaft design**  
**Uses IEC standard motors**



**Standard with high quality Silicon Carbide mechanical seal**



**All the hydraulic and wetted components are manufactured in 316 Stainless Steel**

This series of stainless steel pumps feature a unique one piece volute casing that is produced using an advanced computer controlled Plasma stamping system that ensures total quality control during manufacture. With the smooth surfaces of stamped stainless steel, this results in consistent high standard products, of superior quality and high efficiency. (Cast casing on 65-250 & 80 models)

The back pull-out construction permits the disassembly and overhaul of the impeller, mechanical seal and motor without removal of the suction or discharge piping, or pump casing.

The centre line discharge and foot support under the casing ensure maximum resistance to misalignment and distortion from pipe loads.

**Available as pump end kit (without motor)**

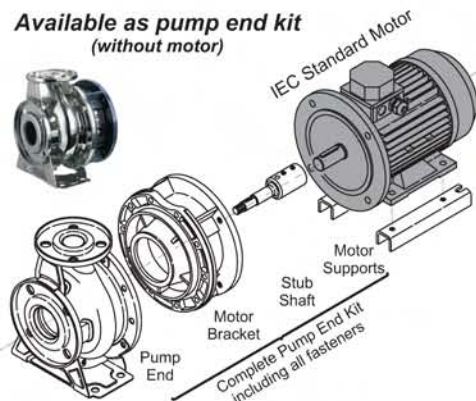

**Standard IEC motors used, allowing for special enclosure, or specific brand motors to be fitted.**

**Specifications**

- Stainless steel pump with closed impeller
- Maximum working pressure : 10 bar
- Liquid temperature: -10°C to +110°C

**Materials**

- Pump casing: 316 Stainless Steel
- Impeller: 316 Stainless Steel
- Casing cover: 316 Stainless Steel
- Shaft : 316 Stainless Steel
- Motor bracket: Cast Iron
- Mech. seal: Silicon Carbide/Silicon Carbide/Viton

**Motor Data**

- IEC standard 4 pole 50 Hz motors
- Normally fitted with WEG motors
- 3 phase, TEFC, IP55, Class F

**Range**

- 0.25 to 7.5 kW - 3 phase
- 32mm Ø to 80mm Ø discharge

**Options**

- Available as pump end kit without motor
- Other motor brands, types, etc. on request.



**Precision cast casing on 65-250 & 80 models**

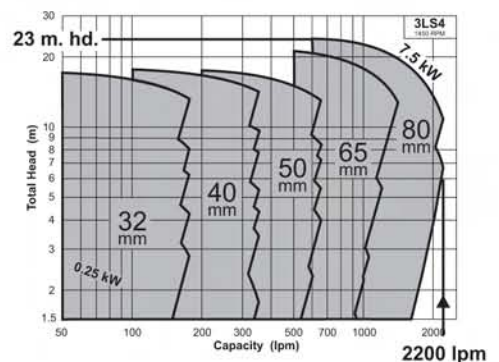

- Over 35 model sizes
- 32mm to 80mm discharge
- 0.25 to 7.5 kW motor power
- Flows to 2200 lpm
- Heads to 23 metres

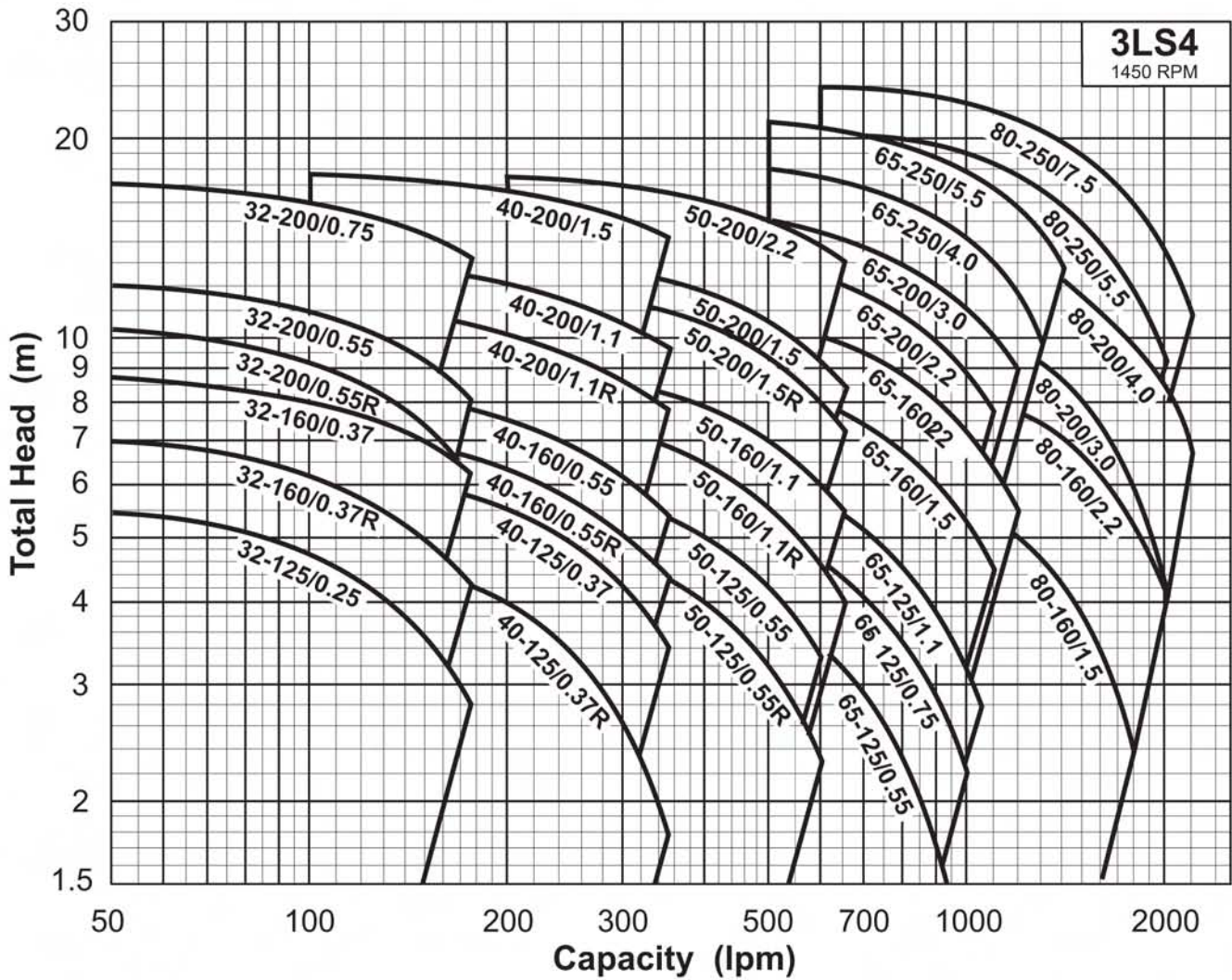

**Model Code**

3LS4 50 - 160 / 1.5 R

- Reduced Diameter Impeller
- Motor Size kW
- Nominal Impeller Diameter mm
- Discharge Size Ømm
- 4 = 4 Pole speed
- Model; 3LS with motor; 3LSF without motor (kit)

Synchronous Speed: 3000 r.p.m.  
Water temp: 20°C

Applicable standard of test: ISO 2458 Class C

**Configuration**

3LS4 pumps use IEC standard motors. 3 phase WEG cast iron motors are generally fitted as standard, but single phase, specific brands, special enclosures, etc. can also be supplied. The requirements for frame size and mounting are in the dimension table. Note that B5 = Flange mount; B35 = Foot & Flange mount. The style of motor support varies depending on model and motor size, as shown in the figures below and referred to in the dimension table.

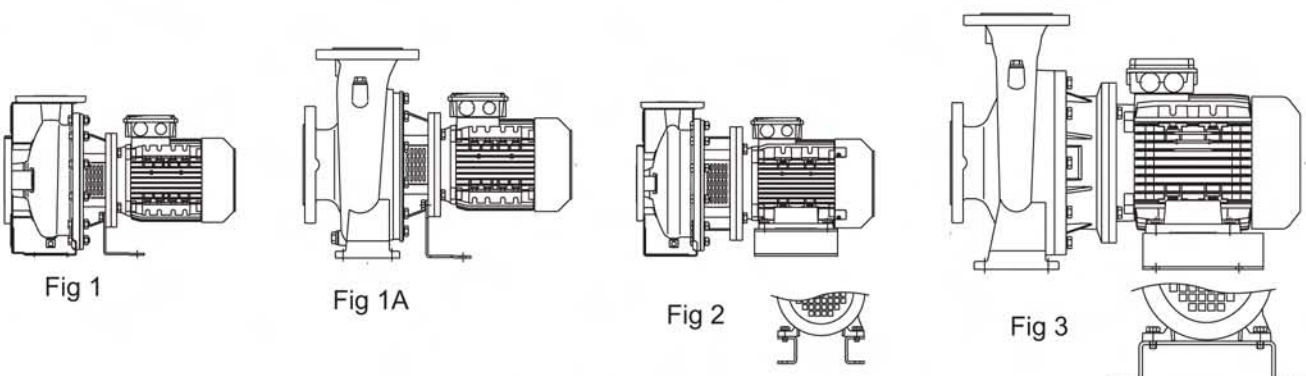

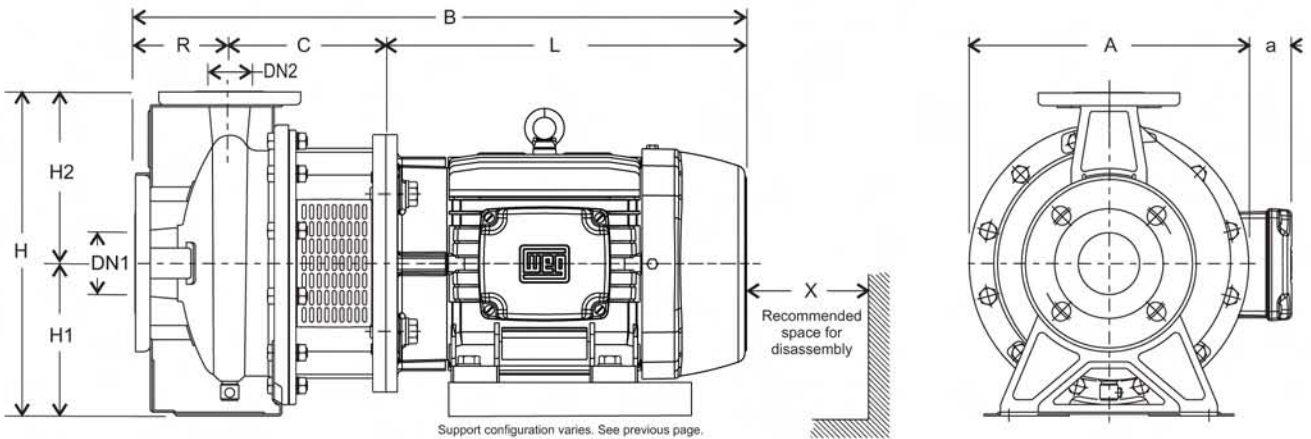

Dimensions & weights refer to units fitted with standard 3 phase cast iron WEG motors

DN2 x DN1	Pump Model (...../kW)	Motor details			Dimensions (mm)										Weight (kg)		
		Frame	Mount	Config.	H1	H2	H	R	C	L	B	A	a	X	Pump End	Motor	Total
32 mm x 50 mm	3LS4 32-125/0.25	71	B5	Fig 1	112	140	252	80	108	218	406	213	21	110	15	11	26
	3LS4 32-160/0.37R	71	B5	Fig 1	132	160	292	80	108	218	406	254	-	110	20	11	31
	3LS4 32-160/0.37	71	B5	Fig 1	132	160	292	80	108	218	406	254	-	110	20	11	31
	3LS4 32-200/0.55R	80	B5	Fig 1	160	180	340	80	118	236	434	296	-	110	24	14	38
	3LS4 32-200/0.55	80	B5	Fig 1	160	180	340	80	118	236	434	296	-	110	24	14	38
	3LS4 32-200/0.75	80	B5	Fig 1	160	180	340	80	118	236	434	296	-	110	24	16	40
40 mm x 65 mm	3LS4 40-125/0.37R	71	B5	Fig 1	112	140	252	80	108	218	406	213	21	115	17	11	28
	3LS4 40-125/0.37	71	B5	Fig 1	112	140	252	80	108	218	406	213	21	115	17	11	28
	3LS4 40-160/0.55R	80	B5	Fig 1	132	160	292	80	118	236	434	254	9	115	20	14	34
	3LS4 40-160/0.55	80	B5	Fig 1	132	160	292	80	118	236	434	254	9	115	20	14	34
	3LS4 40-200/1.1R	90S	B5	Fig 1	160	180	340	100	130	254	484	296	7	115	27	24	51
	3LS4 40-200/1.1	90S	B5	Fig 1	160	180	340	100	130	254	484	296	7	115	27	24	51
50 mm x 65 mm	3LS4 40-200/1.5	90L	B5	Fig 1	160	180	340	100	130	279	509	296	7	115	27	25	52
	3LS4 50-125/0.55R	80	B5	Fig 1	132	160	292	100	118	236	454	254	9	125	21	14	35
	3LS4 50-125/0.55	80	B5	Fig 1	132	160	292	100	118	236	454	254	9	125	21	14	35
	3LS4 50-160/1.1R	90S	B5	Fig 1	160	180	340	100	130	254	484	296	7	125	26	24	50
	3LS4 50-160/1.1	90S	B5	Fig 1	160	180	340	100	130	254	484	296	7	125	26	24	50
	3LS4 50-200/1.5R	90L	B5	Fig 1	160	200	360	100	130	279	519	296	7	125	30	25	55
65 mm x 80 mm	3LS4 50-200/1.5	90L	B5	Fig 1	160	200	360	100	130	279	519	296	7	125	30	25	55
	3LS4 50-200/2.2	100L	B35	Fig 2	160	200	360	100	130	316	546	296	17	125	30	35	65
	3LS4 65-125/0.55	80	B5	Fig 1	160	180	340	100	118	236	454	254	9	145	26	14	40
	3LS4 65-125/0.75	80	B5	Fig 1	160	180	340	100	118	236	454	254	9	145	28	16	42
	3LS4 65-125/1.1	90S	B5	Fig 1	160	180	340	100	130	254	484	254	28	145	29	24	53
	3LS4 65-160/1.5	90L	B5	Fig 1	160	200	360	100	130	279	509	296	7	145	30	25	55
	3LS4 65-160/2.2	100L	B35	Fig 2	160	200	360	100	142	316	558	296	17	145	30	35	65
	3LS4 65-200/2.2	100L	B35	Fig 2	180	225	405	100	142	316	558	296	17	145	30	35	65
	3LS4 65-200/3.0	100L	B35	Fig 2	180	225	405	100	142	316	558	296	17	145	30	45	75
80 mm x 100 mm	3LS4 65-250/4.0	112M	B35	Fig 2	200	250	450	100	152	333	585	357	6	150	57	46	103
	3LS4 65-250/5.5	132S	B35	Fig 3	200	250	450	100	152	372	624	357	34	150	57	65	122
	3LS4 80-160/1.5	90L	B5	Fig 1A	180	225	405	125	130	279	534	320	-	150	51	25	76
	3LS4 80-160/2.2	100L	B35	Fig 3	180	225	405	125	142	316	583	320	5	150	51	35	86
	3LS4 80-200/3.0	100L	B35	Fig 3	180	250	430	125	152	316	593	357	-	150	59	45	104
	3LS4 80-200/4.0	112M	B35	Fig 3	180	250	430	125	152	333	610	357	6	150	61	46	107
	3LS4 80-250/5.5	132S	B35	Fig 3	200	280	480	125	175	372	672	367	29	150	58	65	123
	3LS4 80-250/7.5	132M	B35	Fig 3	200	280	480	125	175	410	710	367	29	150	59	80	139

Specifications subject to change without notice

**Flanges to DIN 2532**

DN	32	40	50	65	80	100
P	75	80	95	115	120	135
K	100	110	125	145	160	180
D	140	150	165	185	200	225

- A** Typical with stamped casing  
(i.e. all 32, 40 & 50mm & 65 -125/160/200)
- B** Typical with cast casing  
(i.e. 65-250, & all 80)

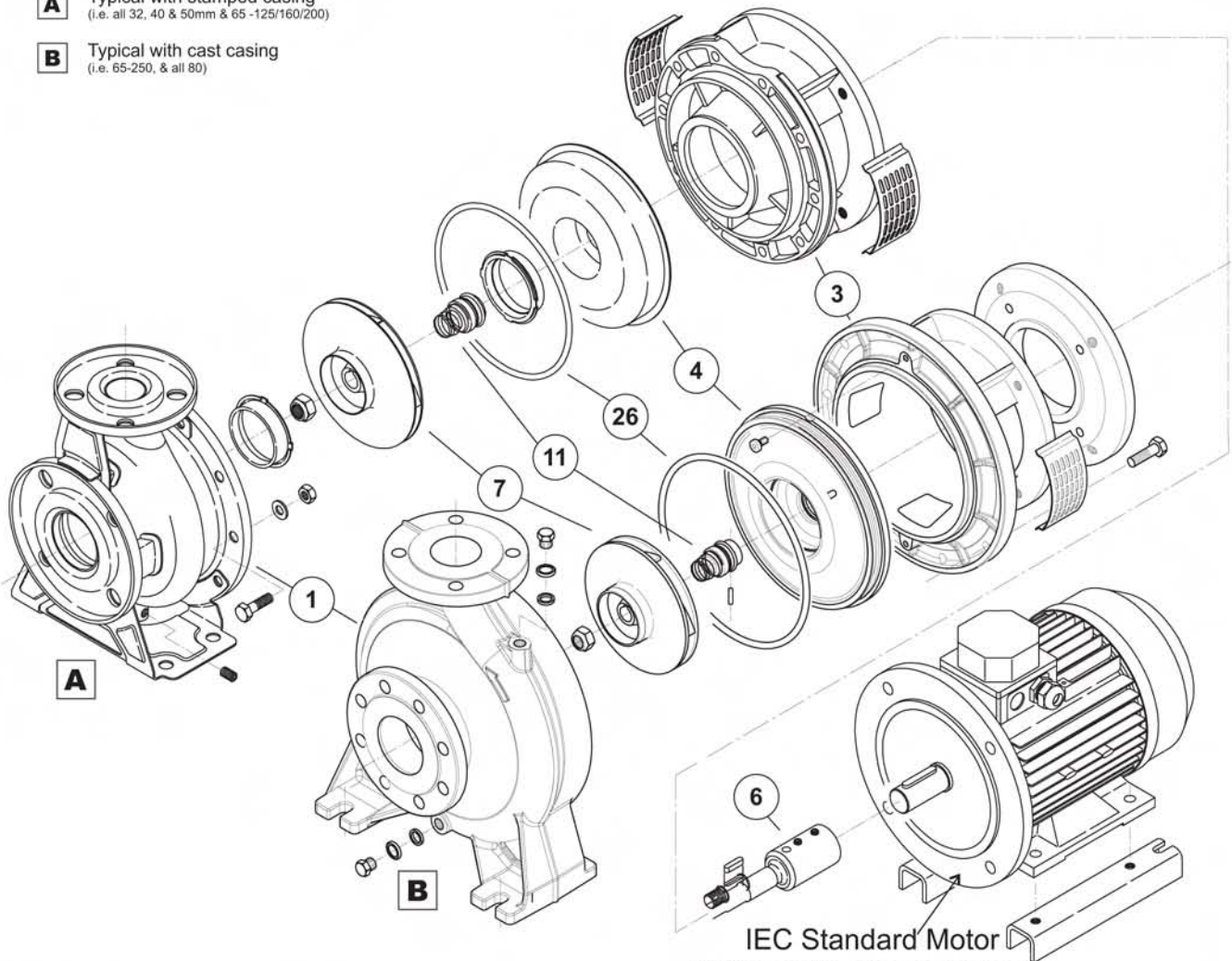

Note: Mounting and support feet varies between models.

Item	Description	Suits models	Materials
1	Casing	All 32, 40 & 50; 65-125/160/200	AISI 316L Stainless Steel - <i>stamped</i>
		65-250: All 80	AISI 316 Stainless Steel - <i>precision cast</i>
7	Impeller	All 32, 40 & 50	AISI 316L Stainless Steel - <i>stamped</i>
		All 65 & 80	AISI 316 Stainless Steel - <i>precision cast</i>
4	Casing Cover	32, 40 & 50; 65-125/160/200; 80-160	AISI 316L Stainless Steel - <i>stamped</i>
		65-250; 80-200/250	AISI 316 Stainless Steel - <i>precision cast</i>
26	O-ring (casing)	All models	Viton
11	Mechanical Seal	All models	SiC/SiC/Viton with anti rotation device for stationary seat.
6	Stub Shaft	All models	(Material refers to part in contact with liquid) AISI 316 Stainless Steel
3	Motor Bracket	All models	Cast Iron

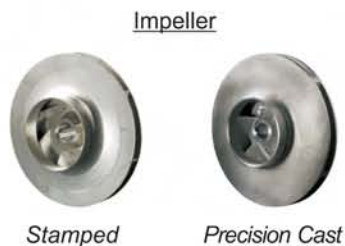

Specifications subject to change without notice