



Robust vertical multistage pumps providing high discharge heads and high efficiencies, with an in-line design requiring minimal floor space for installation.

Features

Uses standard IEC motors, allowing the use of specific brand or enclosure motors if required, and ease of replacement.

Thrust bearing in models over 1.5 kW (3.0 kW for EVMG 18) for improved reliability and ease of assembly.

Installation dimensions to industry standard for easy upgrade or replacement.

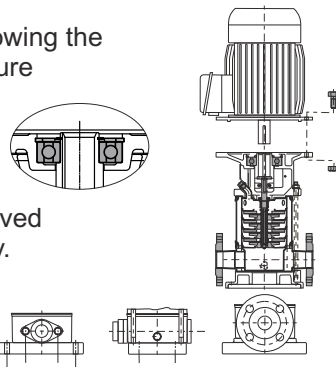

Applications

- Industrial ■ Commercial Buildings ■ Agricultural
- Original Equipment Manufacturers ■ Municipalities

- Pressure boosting
- Irrigation
- Boiler feed
- Fire fighting
- Industrial washing
- Water treatment
- Filtration

Model Code

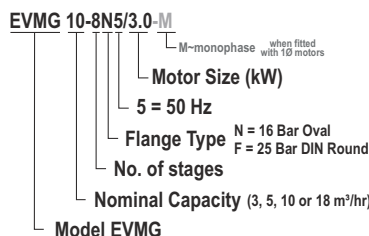

Specifications

- Maximum working pressure : 16 or 25 bar, depending on model. Refer to performance table.
- Maximum liquid temperature: -15°C to +120°C
- Maximum solid content: 50 ppm (size 0.1 to 0.25mm or less)
- Maximum chlorine ion density: 500ppm

Construction

- Vertical multistage in-line pump
- Closed centrifugal impellers
- In built thrust bearing with models above 1.5 kW (above 3.0 kW for EVMG18)

Materials

- Impellers: 304 stainless steel
- Intermediate casings: 304 stainless steel
- Outer casing: 316 stainless steel
- Bottom casing: cast iron
- Top casing: cast iron
- Shaft: 316 stainless steel
- Motor Bracket: cast iron
- Mechanical seal: Silicon Carbide/Carbon/Viton
- Liner Rings: EPDM & 304 SS
- O'Rings: EPDM

Connections

- 16 bar oval flange with screwed companion flange or
 - 25 bar DIN round flange
- Depending on model. See dimension table for details.

Motor Data

- Uses IEC standard motors, face or flange mount
- Depending on model. See dimension table for details.
- Standard
- 3 phase, TEFC, 2 pole motor, Class F, IP55
- Optional
- Single phase motors (upto 7.5 kW)
- Special enclosure or specific brand on request.

Range

- 25mm to 50mm Ø
- 0.37 to 15 kW - 3 phase

Supply

- Can be supplied as pump end without motor.
- Models with oval flange (N type) are supplied with zinc plated steel companion flanges.

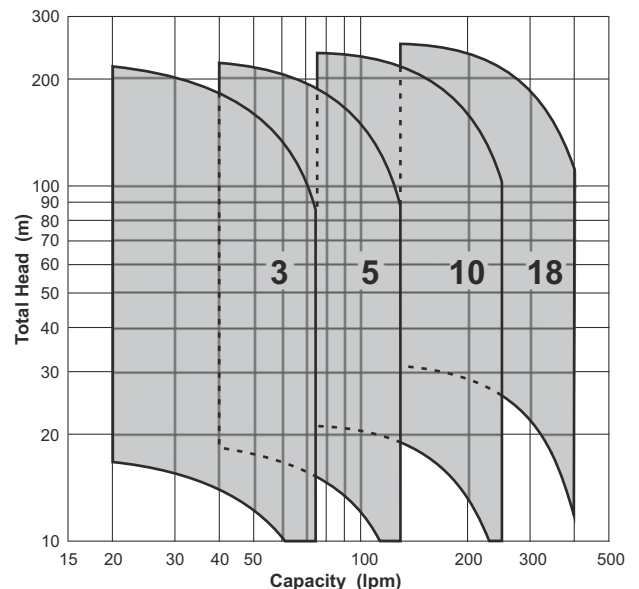

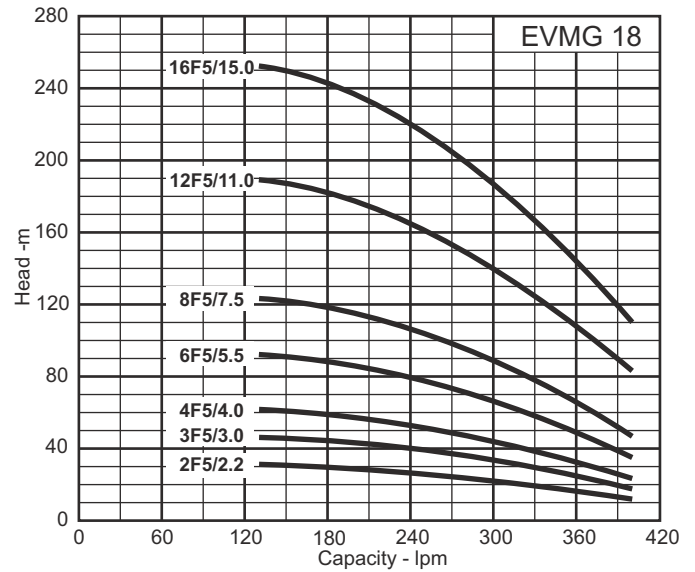
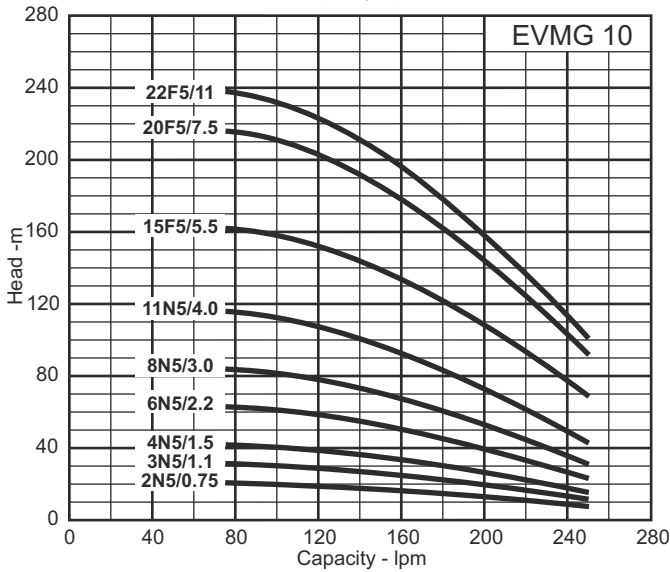
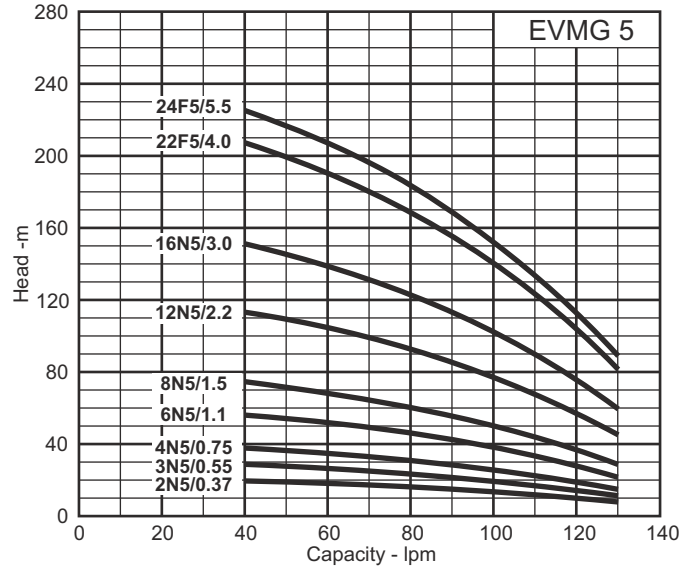
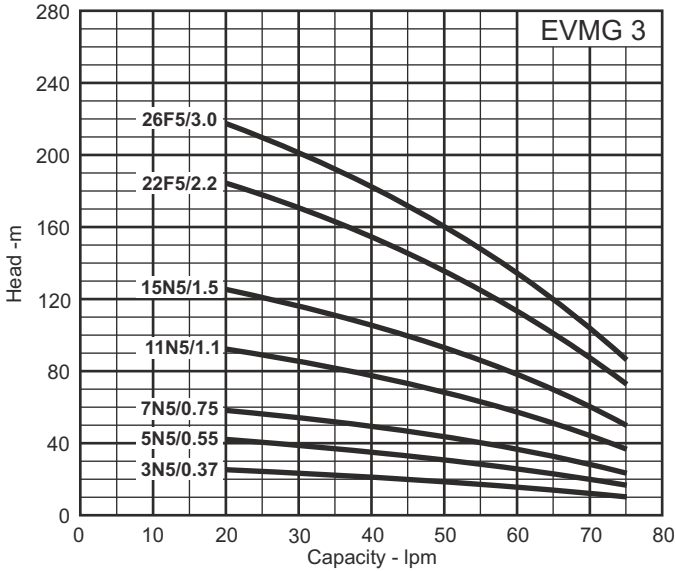

Pump Model	Motor kW	Connections		Maximum Working Pressure	Q= Capacity lpm															
		Size	Type		H= Total head in meters															
					0	20	40	60	75	100	130	150	200	250	300	350	400			
EVMG 3-3N5/0.37	0.37	25 mm	16 Bar Oval flange with screwed companion flange	1.6 MPa	27.9	25.1	20.9	15.5	9.9	-	-	-	-	-	-	-	-	-		
EVMG 3-5N5/0.55	0.55				46.5	42.0	34.9	25.8	16.5	-	-	-	-	-	-	-	-	-	-	
EVMG 3-7N5/0.75	0.75				65.0	58.5	49.0	36.1	23.1	-	-	-	-	-	-	-	-	-	-	
EVMG 3-11N5/1.1	1.1				102.0	92.0	77.0	56.5	36.3	-	-	-	-	-	-	-	-	-	-	
EVMG 3-15N5/1.5	1.5				140.0	125.0	105.0	77.5	49.5	-	-	-	-	-	-	-	-	-	-	
EVMG 3-22F5/2.2	2.2				205.0	184.0	154.0	113.0	72.5	-	-	-	-	-	-	-	-	-	-	
EVMG 3-26F5/3.0	3				242.0	217.0	182.0	134.0	86.0	-	-	-	-	-	-	-	-	-	-	
EVMG 5-2N5/0.37	0.37	32 mm	16 Bar Oval flange with screwed companion flange	1.6 MPa	20.2	-	18.4	16.9	15.4	12.2	6.9	-	-	-	-	-	-			
EVMG 5-3N5/0.55	0.55				30.2	-	27.6	25.3	23.1	18.4	10.3	-	-	-	-	-	-	-		
EVMG 5-4N5/0.75	0.75				40.5	-	36.8	33.8	30.8	24.5	13.8	-	-	-	-	-	-	-		
EVMG 5-6N5/1.1	1.1				60.5	-	55.0	50.5	46.5	36.7	20.6	-	-	-	-	-	-	-		
EVMG 5-8N5/1.5	1.5				80.5	-	73.5	67.5	61.5	49.0	27.5	-	-	-	-	-	-	-		
EVMG 5-12N5/2.2	2.2				123.0	-	112.0	103.0	94.5	75.5	44.0	-	-	-	-	-	-	-		
EVMG 5-16N5/3.0	3				164.0	-	150.0	138.0	126.0	101.0	58.5	-	-	-	-	-	-	-		
EVMG 5-22F5/4.0	4				225.0	-	206.0	189.0	173.0	139.0	80.5	-	-	-	-	-	-	-		
EVMG 5-24F5/5.5	5.5				246.0	-	224.0	206.0	189.0	151.0	88.0	-	-	-	-	-	-	-		
EVMG 10-2N5/0.75	0.75				40 mm	16 Bar Oval flange with screwed companion flange	1.6 MPa	22.0	-	-	-	21.0	20.4	18.9	17.6	13.2	7.8	-	-	-
EVMG 10-3N5/1.1	1.1	33.0	-	-				-	31.6	30.5	28.4	26.4	19.8	11.7	-	-	-	-		
EVMG 10-4N5/1.5	1.5	44.0	-	-				-	42.0	40.5	37.8	35.2	26.4	15.6	-	-	-	-		
EVMG 10-6N5/2.2	2.2	66.0	-	-				-	63.0	61.0	57.0	53.0	39.5	23.4	-	-	-	-		
EVMG 10-8N5/3.0	3	88.0	-	-				-	84.0	81.5	75.5	70.5	52.5	31.2	-	-	-	-		
EVMG 10-11N5/4.0	4	121.0	-	-				-	116.0	112.0	104.0	97.0	72.5	43.0	-	-	-	-		
EVMG 10-15F5/5.5	5.5	168.0	-	-				-	162.0	158.0	148.0	139.0	108.0	69.0	-	-	-	-		
EVMG 10-20F5/7.5	7.5	224.0	-	-				-	216.0	210.0	197.0	185.0	144.0	92.0	-	-	-	-		
EVMG 10-22F5/11	11	246.0	-	-				-	238.0	231.0	217.0	204.0	158.0	101.0	-	-	-	-		
EVMG 18-2F5/2.2	2.2	50 mm	25 Bar Round DIN flange	1.6 MPa				32.0	-	-	-	-	-	31.0	30.3	28.5	25.7	21.9	17.2	11.6
EVMG 18-3F5/3.0	3				48.0	-	-	-	-	-	46.0	45.5	43.0	38.6	32.8	25.7	17.4			
EVMG 18-4F5/4.0	4				64.0	-	-	-	-	-	61.5	60.5	57.0	51.5	44.0	34.3	23.2			
EVMG 18-6F5/5.5	5.5				96.0	-	-	-	-	-	92.0	91.0	85.5	77.0	65.5	51.5	34.8			
EVMG 18-8F5/7.5	7.5				128.0	-	-	-	-	-	123.0	121.0	114.0	103.0	87.5	68.5	46.5			
EVMG 18-12F5/11	11			194.0	-	-	-	-	-	189.0	186.0	177.0	160.0	139.0	112.0	83.0				
EVMG 18-16F5/15	15			259.0	-	-	-	-	-	-	252.0	249.0	236.0	214.0	186.0	150.0	110.0			

Dimensions

Model **EVMG 3~18**

Units: mm unless otherwise specified

Dimensions H3, C & B may vary depending on motor type fitted.
 Dimensions & weights shown refer to 3 phase motors :-
 - AEG motors 0.37 to 4.0 kW
 - WEG motors 5.5 to 15 kW

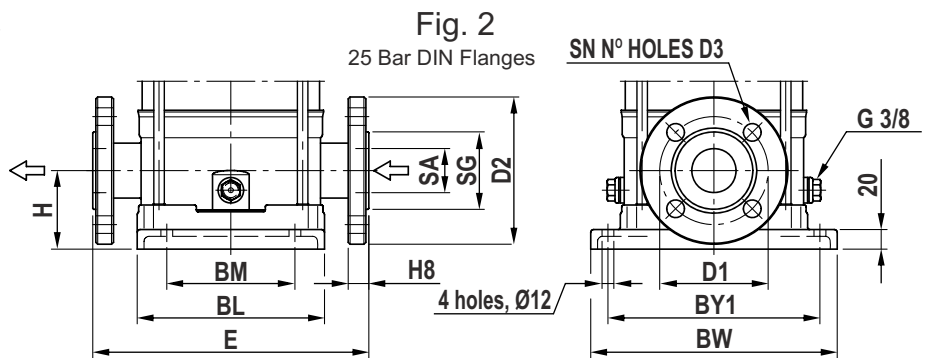
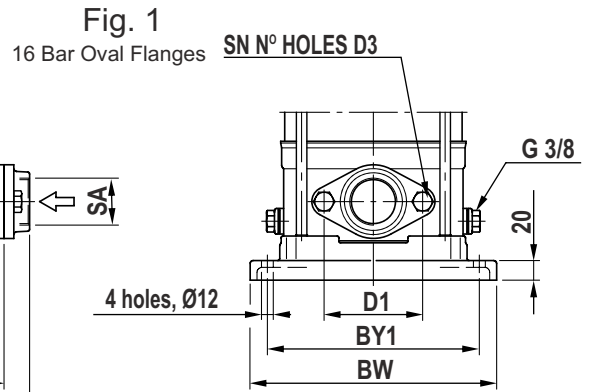
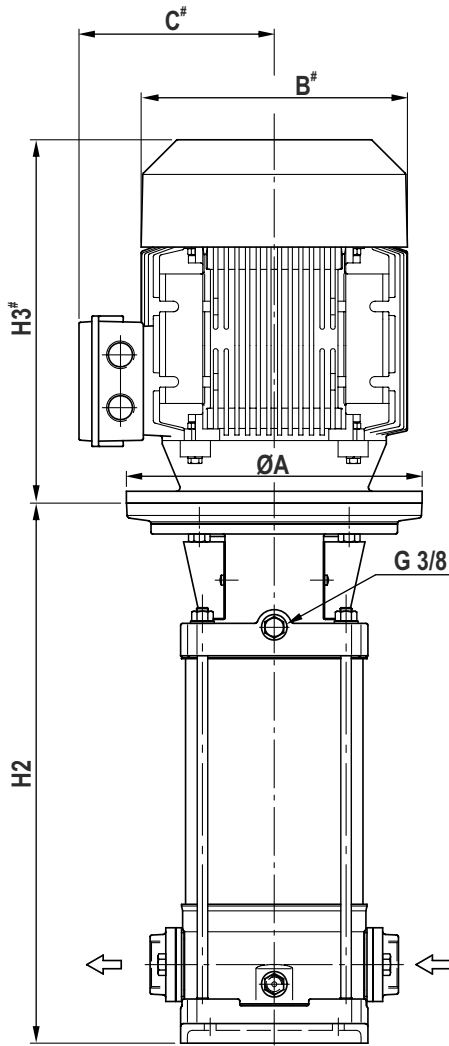

Motor kW	0.37	0.55	0.75	1.1	1.5	2.2	3.0	4.0	5.5	7.5	11.0	15.0
Frame Size	71	71	80	80	90S	90L	100	112	132S	132S	160M	160M
Mount	Vertical Face Mount - B14A (V18)						Vertical Flange Mount - B5 (V1)					

Pump Type	Motor kW	Fig.No for Flange	Dimensions - mm																	Weight#			
			H	H2	H3	F	E	B	C	BM	BL	BY1	BW	SA	SG	D1	D2	H8	SN	D3	A	Pump	Pump Motor
EVMG 3-3N5/0.37	0.37	Fig. 1	50	262	215	160	206	142	112	100	149	180	210	G1"	-	75	-	-	2	M10	Ø105	12	17
EVMG 3-5N5/0.55	0.55		50	304	215	160	206	142	112	100	149	180	210	G1"	-	75	-	-	2	M10	Ø105	13	19
EVMG 3-7N5/0.75	0.75		50	356	232	160	206	160	129	100	149	180	210	G1"	-	75	-	-	2	M10	Ø120	14	22
EVMG 3-11N5/1.1	1.1		50	440	232	160	206	160	129	100	149	180	210	G1"	-	75	-	-	2	M10	Ø120	16	26
EVMG 3-15N5/1.5	1.5		50	534	267	160	206	180	138	100	149	180	210	G1"	-	75	-	-	2	M10	Ø140	19	32
EVMG 3-22F5/2.2	2.2		75	717	267	-	250	180	138	100	149	180	210	Ø25	Ø63	Ø85	Ø115	16	4	Ø14	Ø140	27	43
EVMG 3-26F5/3.0	3	75	811	306	-	250	196	145	100	149	180	210	Ø25	Ø63	Ø85	Ø115	16	4	Ø14	Ø160	31	50	
EVMG 5-2N5/0.37	0.37	Fig. 1	50	255	215	160	206	142	112	100	149	180	210	G1 1/4	-	75	-	-	2	M10	Ø105	12	17
EVMG 5-3N5/0.55	0.55		50	283	215	160	206	142	112	100	149	180	210	G1 1/4	-	75	-	-	2	M10	Ø105	12	18
EVMG 5-4N5/0.75	0.75		50	321	232	160	206	160	129	100	149	180	210	G1 1/4	-	75	-	-	2	M10	Ø120	13	21
EVMG 5-6N5/1.1	1.1		50	377	232	160	206	160	129	100	149	180	210	G1 1/4	-	75	-	-	2	M10	Ø120	14	24
EVMG 5-8N5/1.5	1.5		50	443	267	160	206	180	138	100	149	180	210	G1 1/4	-	75	-	-	2	M10	Ø140	16	28
EVMG 5-12N5/2.2	2.2		50	565	267	160	206	180	138	100	149	180	210	G1 1/4	-	75	-	-	2	M10	Ø140	20	36
EVMG 5-16N5/3.0	3	50	688	306	160	206	196	145	100	149	180	210	G1 1/4	-	75	-	-	2	M10	Ø160	23	43	
EVMG 5-22F5/4.0	4	Fig. 2	75	881	306	-	250	196	145	100	149	180	210	Ø32	Ø71	Ø100	Ø140	20	4	Ø14	Ø160	31	59
EVMG 5-24F5/5.5	5.5		75	948	372	-	250	270	184	100	149	180	210	Ø32	Ø71	Ø100	Ø140	20	4	Ø14	Ø300	35	96
EVMG 10-2N5/0.75	0.75	Fig. 1	80	333	232	200	252	160	129	130	190	215	250	G1 1/2	-	100	-	-	2	M12	Ø120	18	26
EVMG 10-3N5/1.1	1.1		80	363	232	200	252	160	129	130	190	215	250	G1 1/2	-	100	-	-	2	M12	Ø120	20	29
EVMG 10-4N5/1.5	1.5		80	403	267	200	252	180	138	130	190	215	250	G1 1/2	-	100	-	-	2	M12	Ø140	22	35
EVMG 10-6N5/2.2	2.2		80	473	267	200	252	180	138	130	190	215	250	G1 1/2	-	100	-	-	2	M12	Ø140	24	40
EVMG 10-8N5/3.0	3		80	543	306	200	252	196	145	130	190	215	250	G1 1/2	-	100	-	-	2	M12	Ø160	31	50
EVMG 10-11N5/4.0	4		80	633	306	200	252	196	145	130	190	215	250	G1 1/2	-	100	-	-	2	M12	Ø160	34	61
EVMG 10-15F5/5.5	5.5	Fig. 2	80	764	372	-	280	270	184	130	190	215	250	Ø40	Ø79	Ø110	Ø150	20	4	Ø18	Ø300	46	107
EVMG 10-20F5/7.5	7.5		80	915	410	-	280	270	212	130	190	215	250	Ø40	Ø79	Ø110	Ø150	20	4	Ø18	Ø300	50	117
EVMG 10-22F5/11	11		80	1005	488	-	280	312	255	130	190	215	250	Ø40	Ø79	Ø110	Ø150	20	4	Ø18	Ø350	56	160
EVMG 18-2F5/2.2	2.2		90	373	267	-	300	180	138	130	190	215	250	Ø50	Ø92	Ø125	Ø165	20	4	Ø18	Ø140	27	43
EVMG 18-3F5/3.0	3		90	423	306	-	300	196	145	130	190	215	250	Ø50	Ø92	Ø125	Ø165	20	4	Ø18	Ø160	29	48
EVMG 18-4F5/4.0	4		90	473	306	-	300	196	145	130	190	215	250	Ø50	Ø92	Ø125	Ø165	20	4	Ø18	Ø160	31	59
EVMG 18-6F5/5.5	5.5	Fig. 2	90	564	372	-	300	270	184	130	190	215	250	Ø50	Ø92	Ø125	Ø165	20	4	Ø18	Ø300	41	102
EVMG 18-8F5/7.5	7.5		90	644	410	-	300	270	212	130	190	215	250	Ø50	Ø92	Ø125	Ø165	20	4	Ø18	Ø300	44	111
EVMG 18-12F5/11	11		90	834	488	-	300	312	255	130	190	215	250	Ø50	Ø92	Ø125	Ø165	20	4	Ø18	Ø350	57	161
EVMG 18-16F5/15	15		90	995	488	-	300	312	255	130	190	215	250	Ø50	Ø92	Ø125	Ø165	20	4	Ø18	Ø350	61	172

2.2 to 4.0 kW models (EVMG 3~10)
4.0 kW models (EVMG 18)

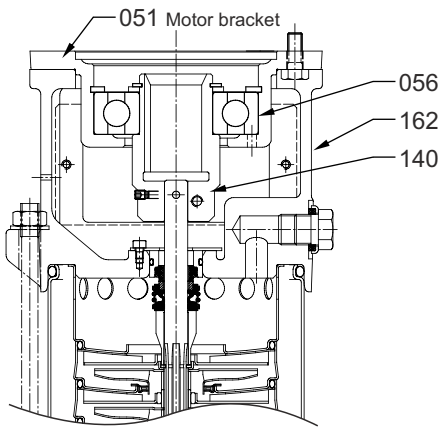

5.5 to 7.5 kW models

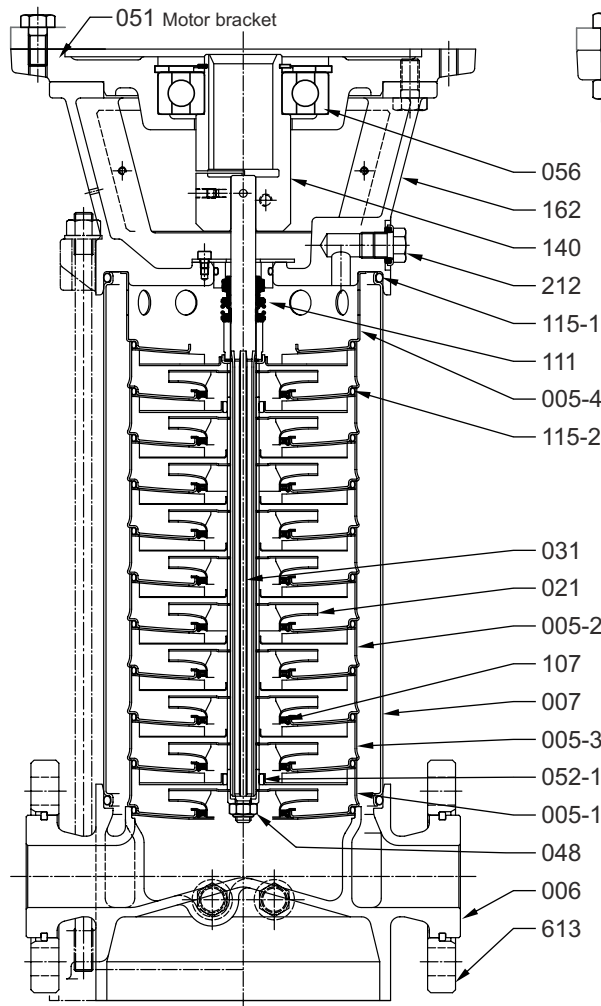

11.0 to 15.0 kW models

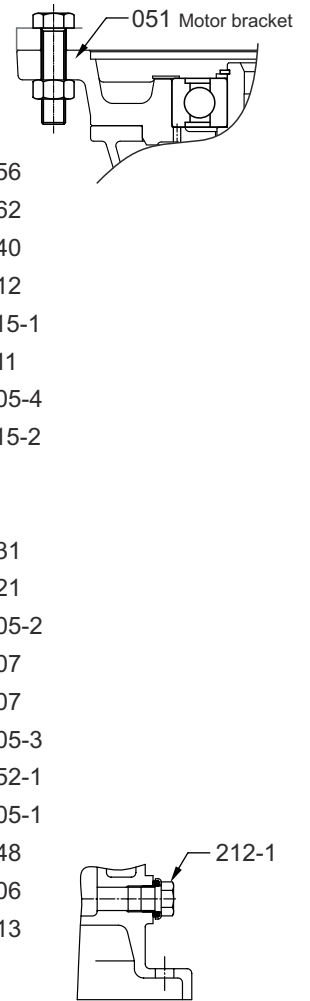

Models without Thrust Bearing
(up to 1.5 kW EVMG 3~10
up to 3.0 kW for EVMG 18)

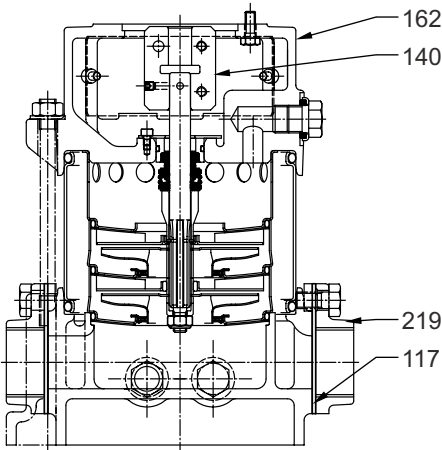

16 Bar Oval Flange
(Models with N type)

← refer to dimension table for applicable models →

25 Bar Round DIN Flange
(Models with F type)

Item	Description	Material	Quantity	
			up to 11 stages	12 stages & above
005-1	Suction cover	304 Stainless steel (AISI 304)	1	
005-2	Intermediate casing	304 Stainless steel (AISI 304)	N-1	N-2
005-3	Intermediate bearing casing	304 Stainless steel (AISI 304)	1	2
005-4	Discharge casing	304 Stainless steel (AISI 304)	1	
006	Bottom casing	Cast iron (EN-GJL-200)	1	
007	Outer casing	316 Stainless steel (AISI 316)	1	
021	Impeller	304 Stainless steel (AISI 304)	N	
031	Shaft	316 Stainless steel (AISI 316)	1	
048	Impeller nut	304 Stainless steel (A2-70)	1	
051	Motor adaptor	Cast iron (EN-GJL-200)	1	#
052-1	Bearing	Tungsten carbide	1	2
056	Ball bearing (thrust)	- (refer to table opposite)	1	#
107	Liner ring	EPDM & 304 Stainless steel	N	
111	Mechanical seal	Silicon carbide/Carbon/Viton	N	
115-1	O' Ring (Outer casing)	EPDM	2	
115-2	O' Ring (Intermediate casing)	EPDM	N+1	
117	Flange gasket	EPDM	2	*
140	Coupling	Brass (OT58) / Steel <small>CF35 SMn Pb10 11 & 15 kW models</small>	1	
162	Motor bracket	Cast iron (EN-GJL-200)	1	
212	Plug	304 Stainless steel (AISI 304)	1	
212-1	Plug	304 Stainless steel (AISI 304)	2	
219	Counter flange	Zinc plated steel	2	*
613	Flange	Carbon steel	2	+

N = Number of stages

- Models with thrust bearings

* - Models with oval flange (N type)

+ - Models with round flange (F type)

Motor kW	Thrust Bearing Size			
	3	5	10	18
2.2 kW	6207 ZZ			No Brg
3.0 kW	6308 ZZ			
4.0 kW	6308 ZZ			
5.5 kW	6310 ZZ			
7.5 kW	6310 ZZ			
11.0 kW	6313 ZZ			
15.0 kW	6313 ZZ			

Specifications subject to change without notice